

SKF 1305 EKTN9 + H 305参数

主要尺寸	d_1	20	mm	-
	D	62	mm	-
	B	17	mm	-
基本额定载荷	C	19000	N	动载荷
	C_0	5400	N	静载荷
疲劳载荷极限	P_u	280	N	-
额定转速	参考转速	22000	r/min	-
	极限转速	15000	r/min	-
重量	重量	330	g	-
型号	轴承+紧定套	1305 EKTN9 + H 305	-	-

SKF 1305 EKTN9 + H 305图片

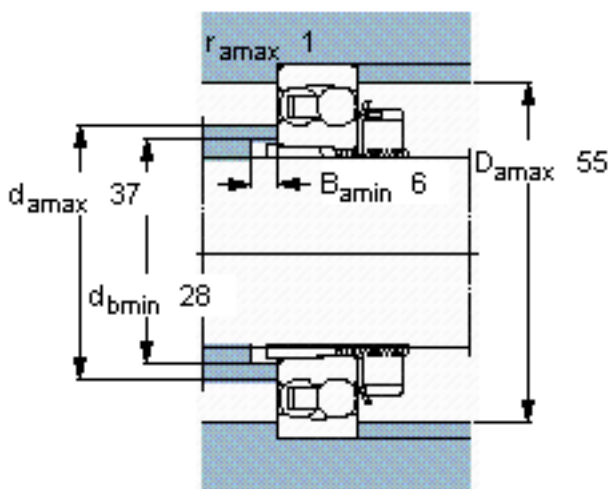
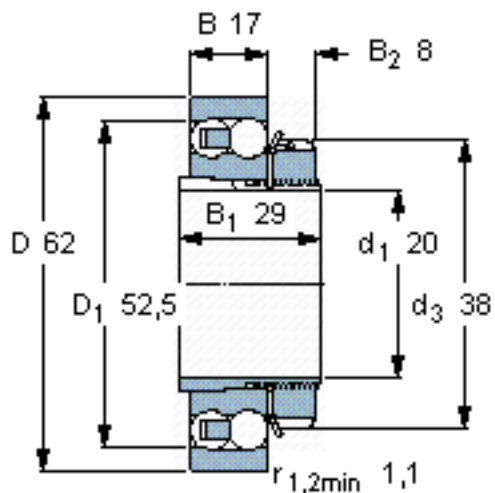

计算系数

- e 0,28
- Y_1 2,2
- Y_2 3,5
- Y_0 2,5

参考资料:<http://www.sozhou.com/p/682acf85.html>

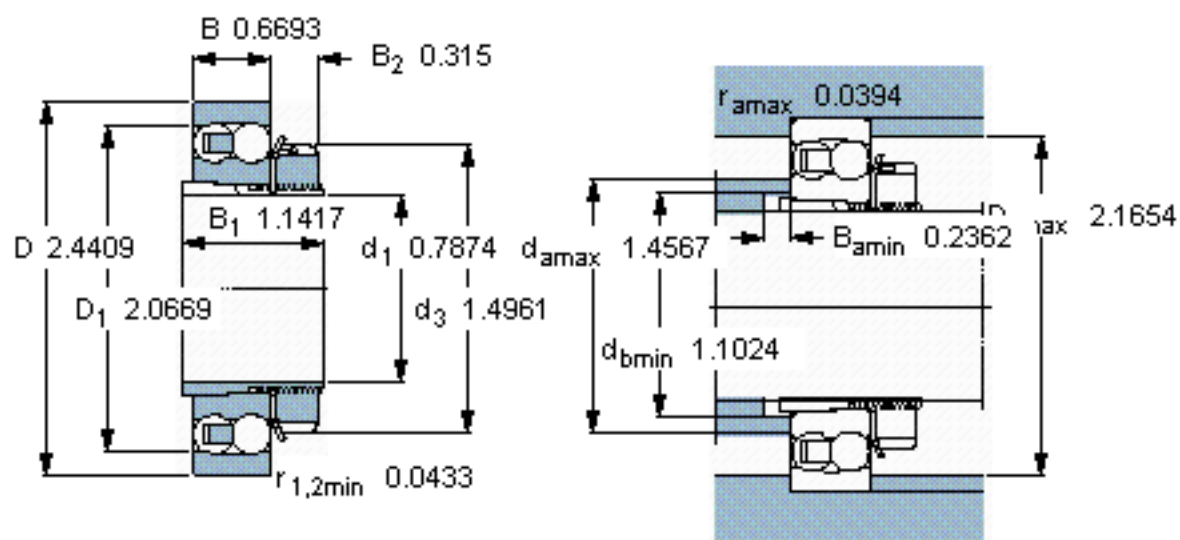

计算系数

$e = 0,28$

$Y_1 = 2,2$

$Y_2 = 3,5$

$Y_0 = 2,5$